

BANCADAS
LABORATÓRIO DE CIÊNCIAS

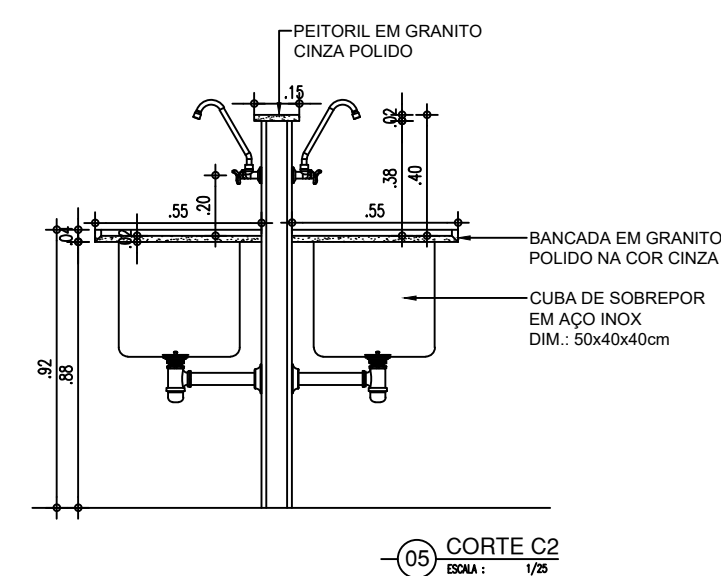

BANCADA LABORATÓRIO DE INFORMÁTICA
1/25

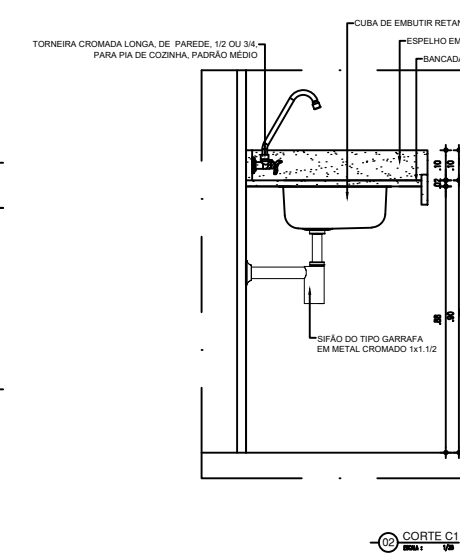
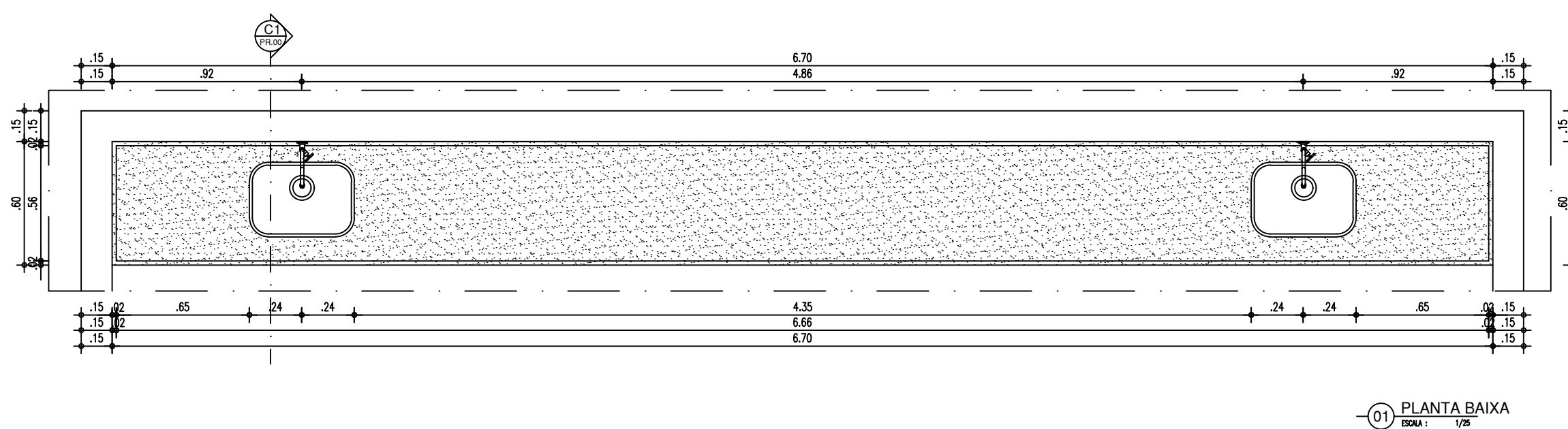
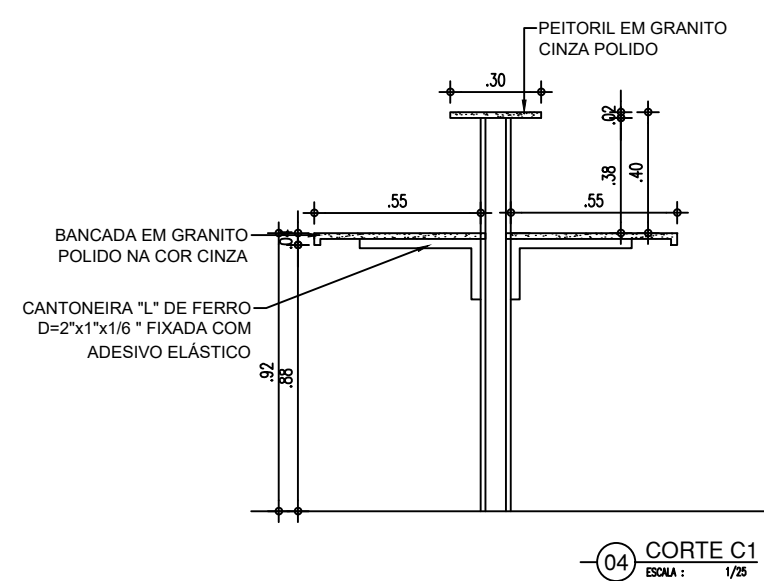
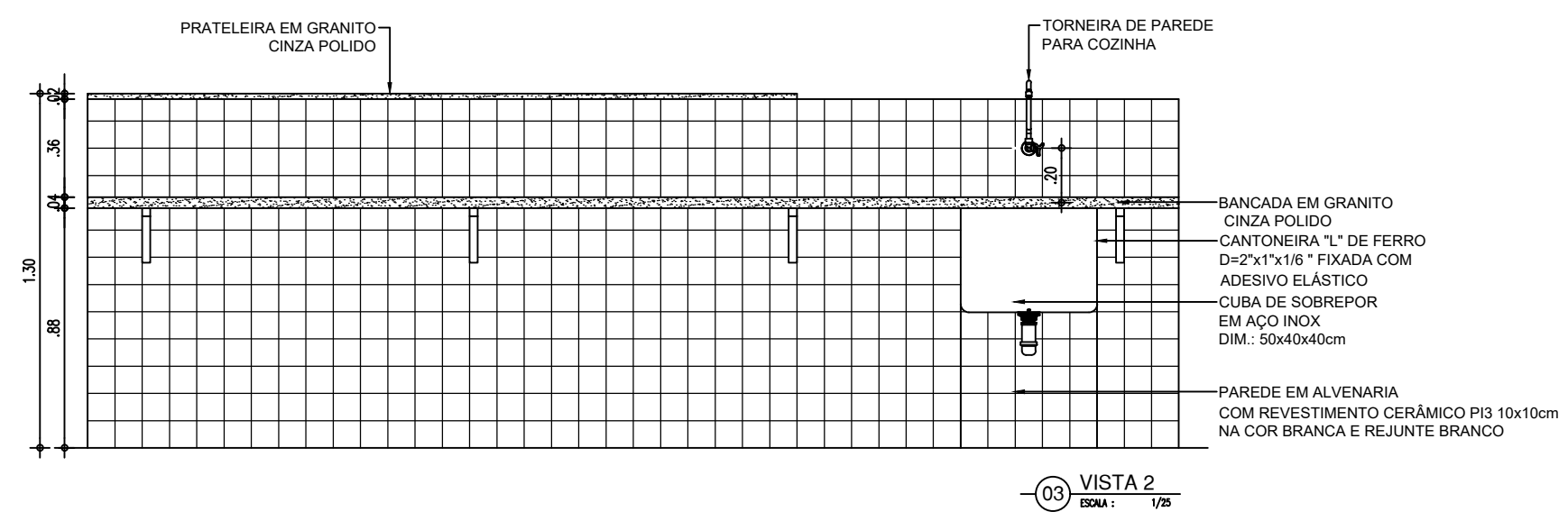
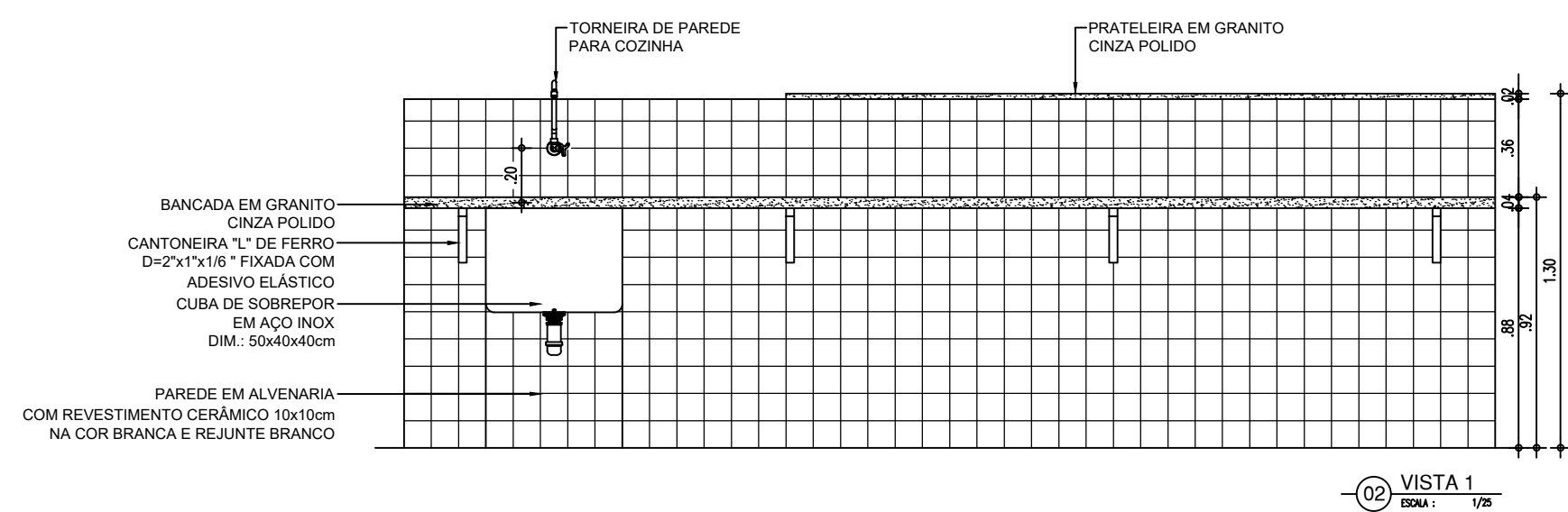
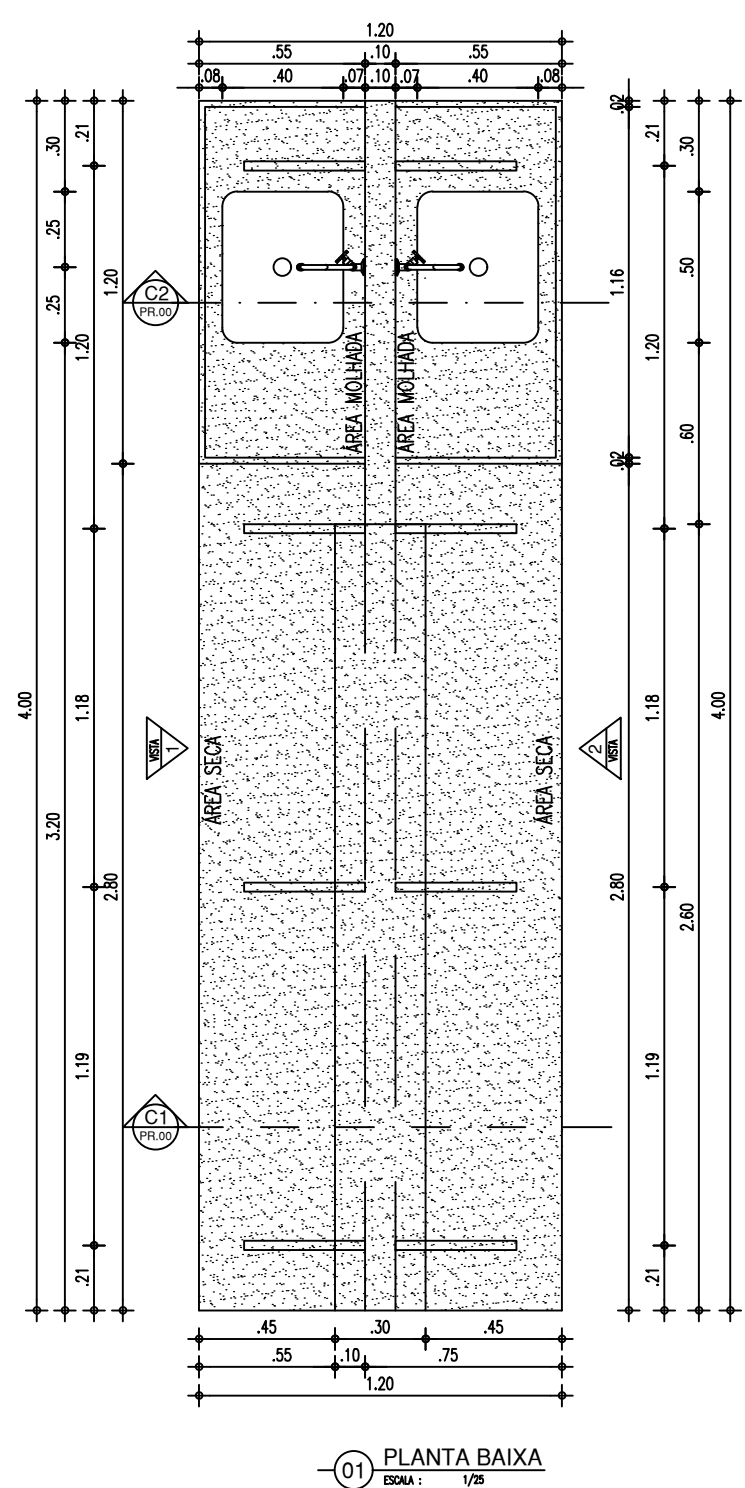
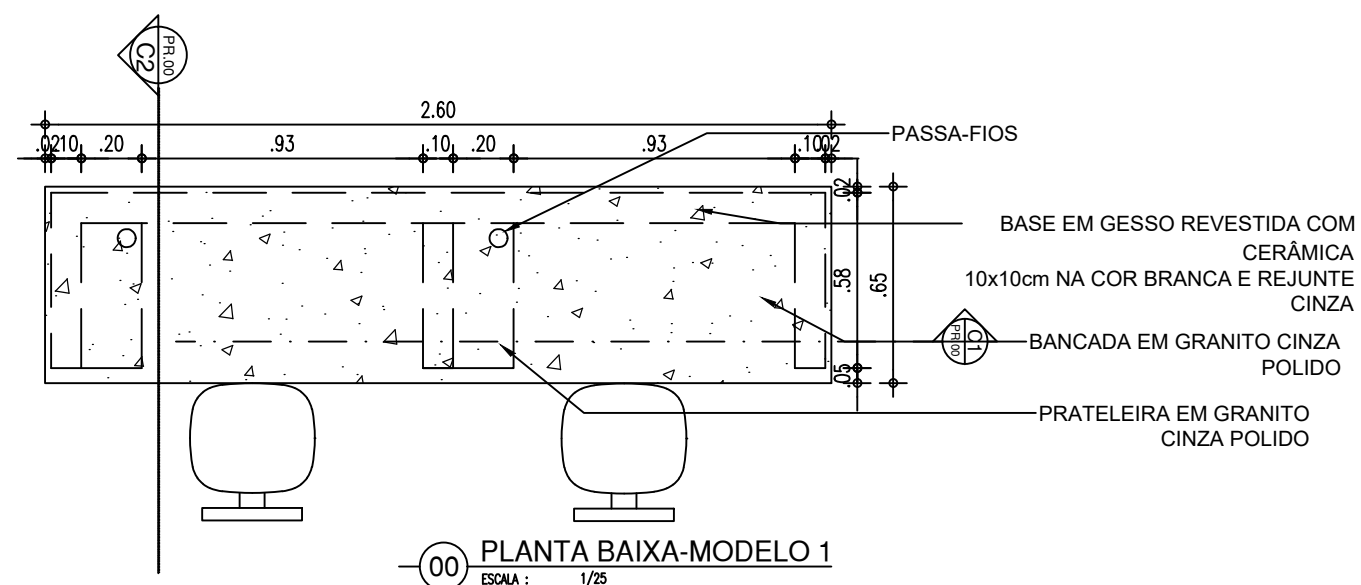
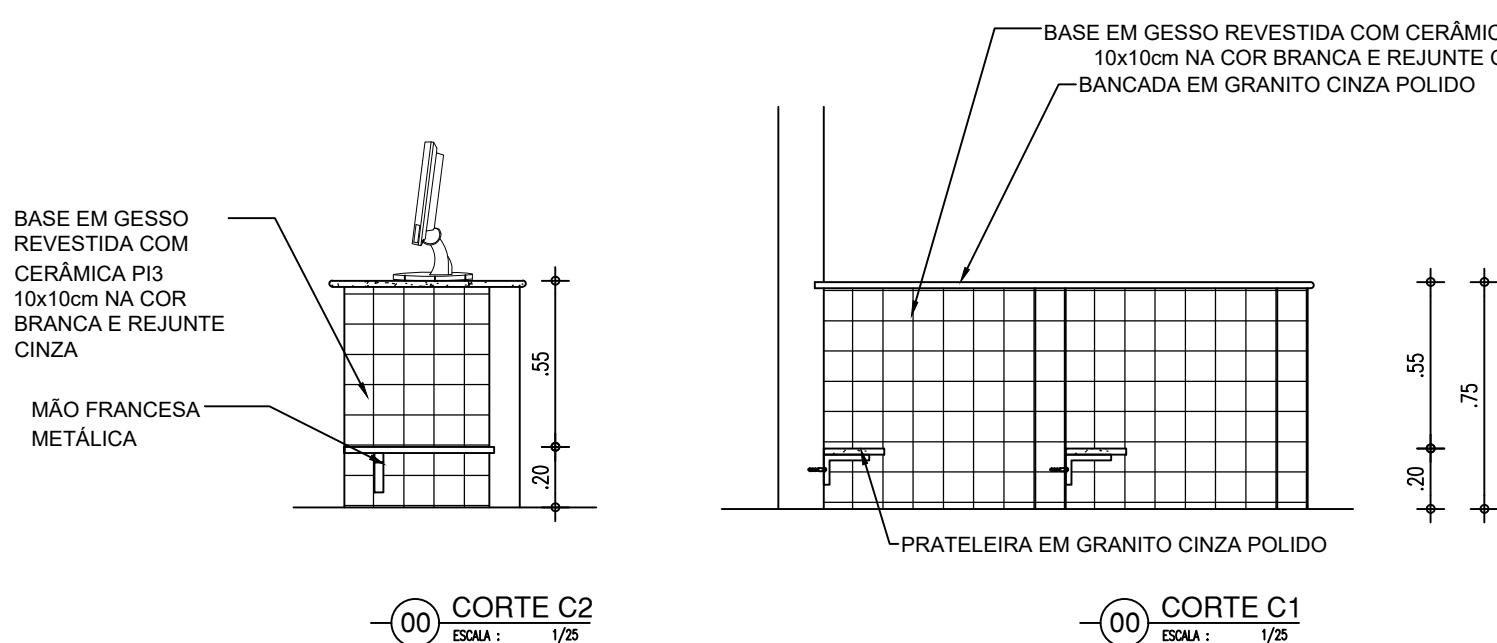

BANCADA BIBLIOTECA

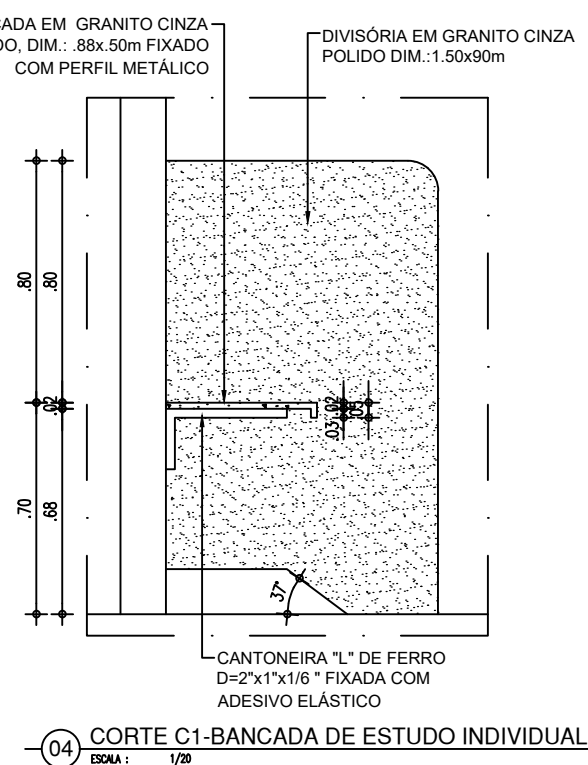
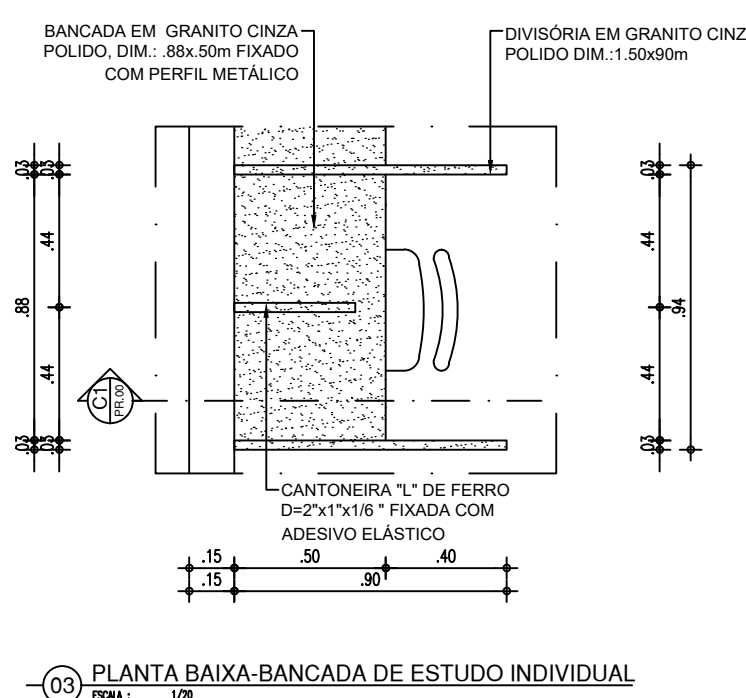
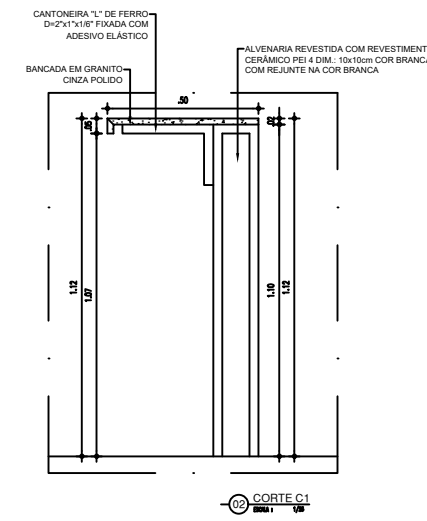
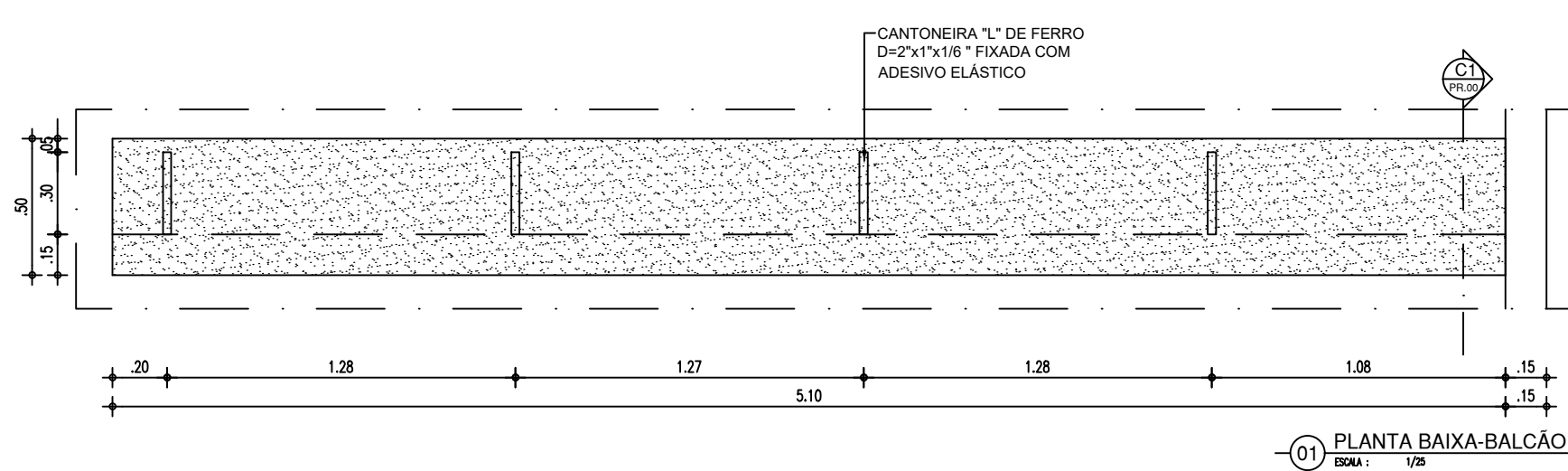

HISTÓRICO		
ALTERAÇÃO	REVISÃO	DATA
1.		
2.		
3.		
4.		
5.		

ARQUITETO(A):	ENGENHEIRO(A) RESPONSÁVEL:	PROPRIETÁRIO:
---------------	----------------------------	---------------



GOVERNO DO ESTADO DO PIAUÍ

SEDUC - SECRETARIA DE ESTADO DA EDUCAÇÃO

UNIDADE ESCOLAR DESEMBARGADOR HÉLI SOBRAL

DEPARTAMENTO: UNIDADE DE GESTÃO DA REDE FÍSICA	DESENHO: PE
TÍTULO DO PROJETO: PROJETO DE REFORMA E AMPLIAÇÃO	PRANCHA: 12/12
ENDEREÇO DO SERVIÇO: RUA JORNALISTA JOSÍPIO, S/N, MOCAMBINHO	ESCALA: 1/25
TÍTULO DO DESENHO: DETALHAMENTO DE BANCADAS	REVISÃO: REVISÃO 00
MUNICÍPIO: TERESINA- PI	ZONA: URBANA
DESENHO: ANDRÉ LIMA	FASE: PROJETO EXECUTIVO
	DATA: OUTUBRO / 2021